

INSTRUCTIONS FOR 2015 & UP AXYS / 2021 & UP MATRYX POLARIS CHASSIS

Congratulations on the purchase of your **BITEHARDER® SNOWMOBILE WHITE * OUT SAFETY LIGHT**
part number: **WOL12V-15AX-21MA**

This product is made with the highest quality materials, to exacting specifications, that will provide you with years of trouble-free use. Your White-Out Safety Light kit is designed to be used with your snowmobile turned off or running. Because the LED lights only draw five watts of power, you can leave the White-Out Safety Lights on for several hours without affecting your batteries performance. For snowmobiles without electric start (no battery), please contact the manufacturer (LJE Products) at 603-780-4509 (8:00am to 8:00pm EST) or at info@ljeproducts.com. In addition to these printed instructions, video instructions can be found by activating the included QR codes.

TOOLS / SUPPLIES NEEDED (Not supplied):

Heat gun / Hair dryer	Zip ties	1/4" drill bit
Phillips screwdriver	Utility knife	3/4" spade (finish) bit or step bit
10 MM wrench	Drill	

AXYS INSTRUCTIONS



MATRYX INSTRUCTIONS

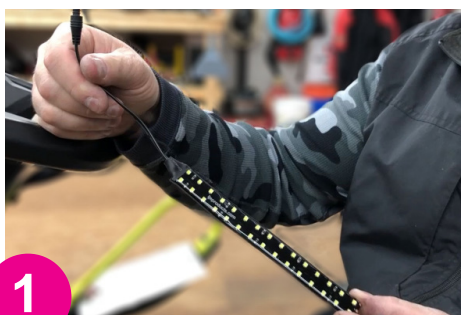

- Remove the hood assembly as per the instructions in your owner's manual.
- Surfaces need to be clean and free of any oil or other contaminants for proper adhesion of components with 3M adhesive tape.
- Unplug the White-Out LED strips from the wiring harness.
- Use a heat gun to heat the area where the LED strip is to be applied. Heat approximately to 100-110 degrees. (do not overheat-just warm to the touch!) This will help the 3M adhesive to bond to the plastic better and prevent any adhesive failures.
- Remove the 3M liner from the back of the LED strip and adhere it with the wire facing up. Make sure to keep the LED strips tight to the body work. Tuck the wire in between the bodywork and the bumper.
- Repeat this process on the other side.
- Unravel the White-Out Safety Light wiring harness, and familiarize yourself with the components.
- From the exhaust side, route the wiring harness behind the coolant bottle, through the engine bay, and behind the frame support on the opposite side. Make sure to route the wiring harness away from the steering column.



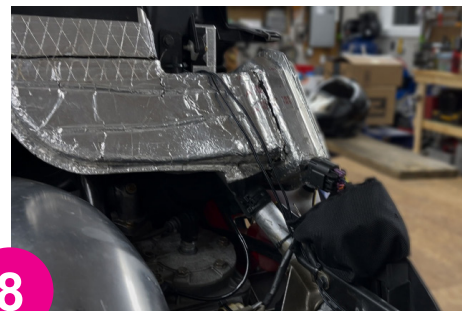

- Run the wire behind the spare belt holder and along the bumper. Leave enough excess so that the wire connector is about 6" away from the belt holder. Connect the harness "quick connects" to the LED light strip leads. Secure the harness to the bumper with a zip tie on either side of the spare belt holder. Work your way back through the engine bay and secure the wires with additional zip ties making sure not to contact any moving or sharp parts.



- Using one of the supplied alcohol wipes, clean three spots on the inside of the nose where you will attach the adhesive wire clamps; one on the left, one in the middle, and one on the right.
- Run the wire from the right LED strip through the wire clamps, and across to the left side.
- Next, connect the wires from the LED strips to the main harness, which should be located on the left side at this point. Secure the excess harness to the bumper with zip ties. Connect the quick connects together on each side of the harness.



- Next, you will need to gain access to the battery. To do so, remove the two plastic rivets securing the console panel to the chassis. Then remove the plastic rivet securing the fender to the chassis. Disconnect the black (negative) battery cable first. Disconnect the red (positive) battery cable next.





- Find the fuse on the wiring harness. Route the red wire through the red battery boot, and attach the wiring harness red ring terminal to the positive battery terminal. Connect the black wire to the existing battery ground along with the factory ground wires. Secure firmly with a 10mm wrench.



- Next, use a 3/4" paddle (finish) / drill bit or step bit to drill a hole in the center of the triangle shaped area between the air intake screen and the recoil on the right side of the snowmobile. For a nice clean cut, drill the hole slowly. Then use the bit to ream the hole out slightly. The switch is metric and needs just over 3/4". View diagram 19 below for switch connections.
- There is foam on the back side of the panel, so once the hole is drilled, take a blade and cut out some of the foam to make room for the switch. Install the switch into the hole with the "I" on the top and the "O" on the bottom, then reconnect the switch to the main harness (as shown).

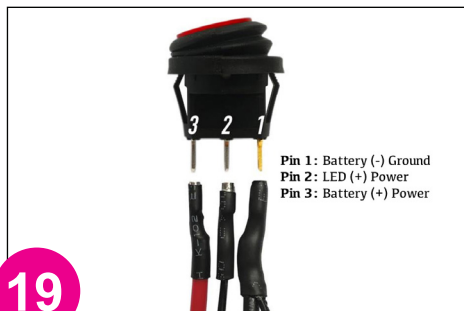

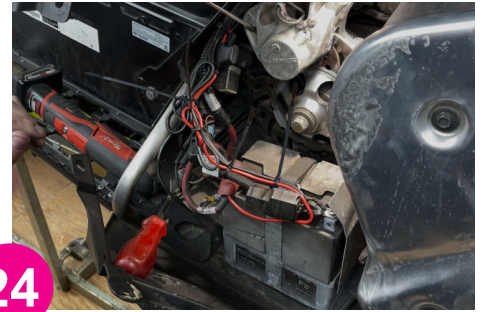
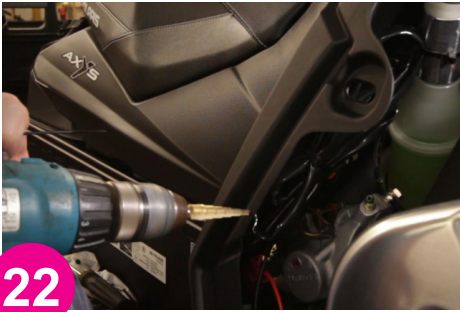

- Bundle the excess harness together, and secure it with zip ties. You want to make sure to keep the wire away from the pull cord and the brake disc. Using a 1/4" drill bit (or a step bit) drill two holes in the lip of the console panel. Run a zip tie through each hole and through the bundled harness. Secure the harness to the panel away from the brake disc.
- Test the lights to make sure they are working properly, and reinstall the bodywork as per the instructions in your owner's manual. Make sure everything is tightly secured and water-tight.
- Congratulations on completing the installation of your new White-Out Safety Lights *

DISCLAIMER:

This light is intended for off-road use only and is intended for additional lighting while riding at night. Failure to check with state and local laws before installing could result in removal of the light, a fine, or other legal action. The installation of this kit does require some mechanical ability. These instructions and associated videos must be followed to avoid personal injury. Any issues regarding the installation of this kit can be answered by calling the manufacturer at 603-780-4509 (8:00am to 8:00pm EST), or by email to info@lje.products.com.

SAFETY WARNINGS:

When assembled correctly, **BITEHARDER®** White-Out Safety Lights will not interfere with the proper operation of you snowmobile. Improper installation could result in a short circuit, loss of power, or fire. Please follow all printed instructions, video instructions, or contact us directly at the phone number and/or email provided above.

LIMITED WARRANTY:

BITEHARDER® White-Out Safety Lights come with a one-year limited warranty. If the White-Out Safety Lights should fail within the warranty period, **BITEHARDER®** will replace any damaged components or the entire assembly at no cost. Please mail failed component(s) to: **BITEHARDER®** 516 Province Road, Laconia, NH 03246. Failure to install your Safety Lights kit per these instructions may void this warranty. Designed and manufactured for **BITEHARDER®** by LJE Products.

